

**PROJECT: THE WHITE HOUSE VISITORS ENTRANCE
 ARCHITECT: WILEY & WILSON
 WASHINGTON, D.C - PLATE #13**

The new Visitors Entrance at the White House looks like a limestone Palladian garden pavilion with tall french windows separated by Jeffersonian columns and ashlar pier blocks.

Built in 1983, the new security building houses the magnetometer which are used to check as many as 8,000 visitors per day.

The pavilion is situated directly opposite the Department of the Treasury Building on East Executive Drive and is built into a heavily planted earth berm so that it is visible only from the street.

The building is clad entirely with Cast Stone selected to match the limestone facade of the Treasury Building and consists of ashlar blocks, pilaster blocks, columns and a band of stone completely encircling the roof line comprising the frieze, cornice, parapet and coping.

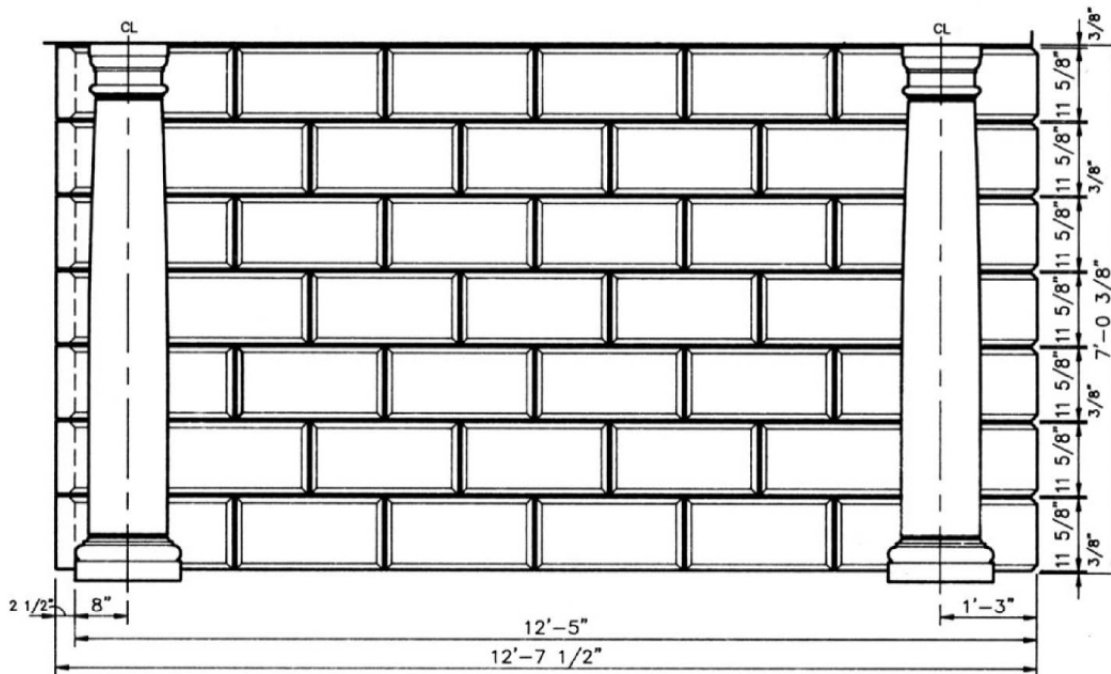

ELEVATION OF PANELS

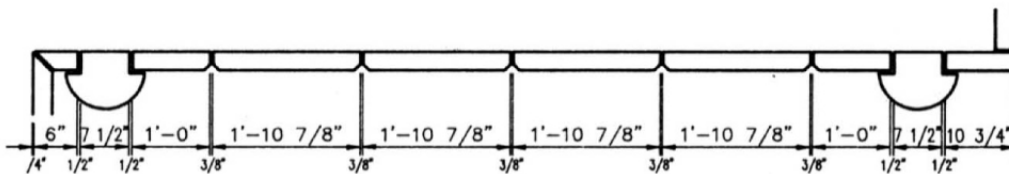

PLAN AT COURSE 1, 3, 5, & 7

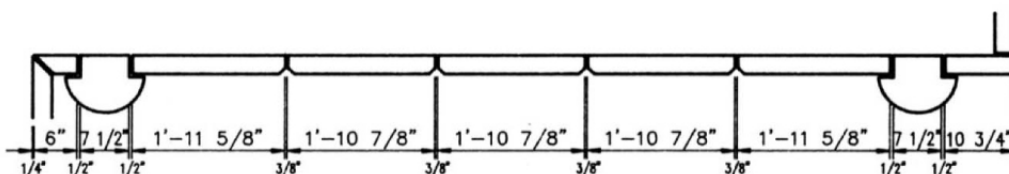

PLAN AT COURSE 2, 4, & 6

This Technical Bulletin is provided by the Cast Stone Institute®, and is intended for guidance only. Specific details should be obtained from the manufacturer or supplier of the Cast Stone units.