

**BUILDING STONE ANCHORS
ANCHORS - PLATE #32**

Standard masonry anchors are preferred over embedded hardware for use with Cast Stone. They are reliable, time-tested, and commercially available, need not be specially fabricated and afford great flexibility in meeting jobsite conditions.

Non-corrosive type anchors should be used for all anchoring. Stainless steel Type 302 or 304 are the standard type used in this class of work.

Typical sizes shown are 1/8" x 1" straps, 1/4" rods and 1/2" dowels. Dowel holes for 1/2" or 3/4" dowels are usually 1" diameter filled completely with mortar during setting. Anchor slots are typically 3/4" wide and similarly are filled with mortar.

Typical details are not universal. The Cast Stone Institute® strongly recommends that designers consult with the project engineer and Cast Stone Institute® producer member in the early stages of design to determine the appropriate anchoring strategy.

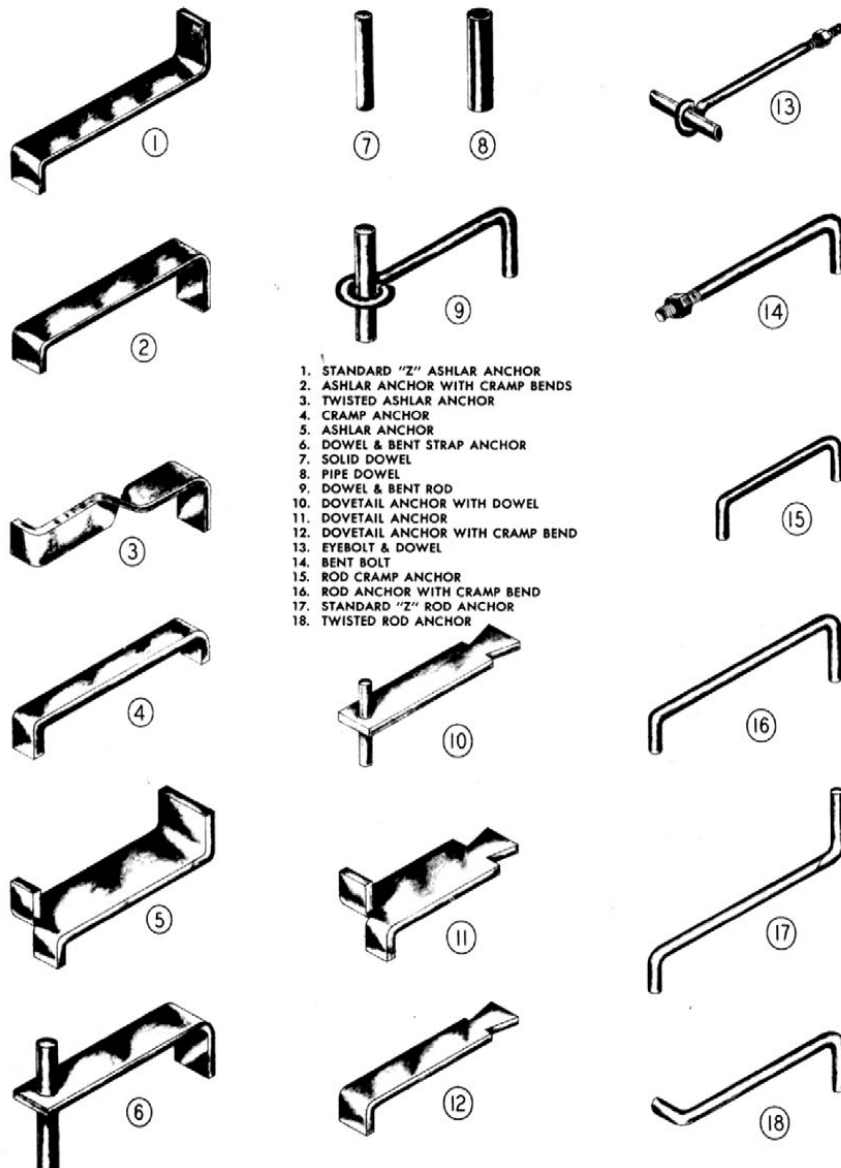

**BUILDING STONE ANCHORS
STANDARD INSERTS**

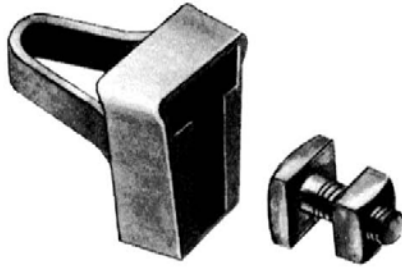

Cast Iron Wedge Insert
Supports weight of the Stone when there is no supporting masonry or steel below.

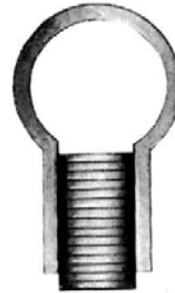

Threaded Loop Insert
Used where adjustment is not required.



Cast Iron Wedge Insert
Same as above, but used primarily for thin panels.

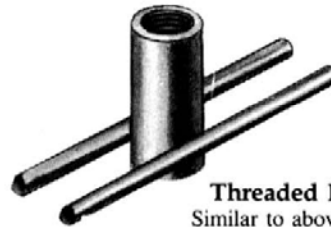

Threaded Insert
Similar to above, but used for thin sections.

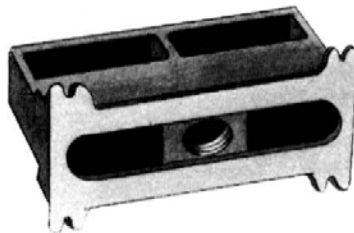

Cast Iron Adjustable Insert
Used to stabilize Stone which is otherwise supported. Allows for horizontal adjustment. Can also be used to hang soffit stones.



PVC Reglet
Used where attachment of flashing is required. Primarily for vertical surfaces.

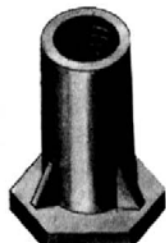

Non-Ferrous Threaded Insert
Used in non-loadbearing applications.

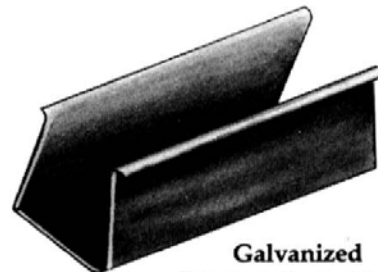

Galvanized Dove Tail Reglet
Used for attachment of flashing. Most economical type of reglet. Also used for anchoring to concrete structures.

————— **Engineering information is available upon request.** —————